



Building Information Modeling / BIM

Imagine if your building- or design project was constructed by objects that were able to think for themselves and calculate their positions compared to other objects. BIM or building information modeling does just that.

Why BIM with us?

By streamlining projects with the implementation of BIM, your company will gain multiple benefits. The project will include fewer flaws, it can be produced more quickly and at a lower cost and the outcome becomes closer related to the initial desire. In other words, investing in the proper work method pays off from the very first project.

Skilled and experienced partner

Here at Cadesign form, we offer a strong set of in-house competencies along with the acquired knowledge and experience, ensuring that your company will enter this digital enhancement of BIM with the greatest support team possible.

Industry experts

We work with companies in various industries. Thus, we have obtained a broad spectrum of knowledge and have become experts in these areas of the industry, ensuring that we provide the needed information to enhance your BIM experience and outcome.

Work smart

This is best done when outsourcing some of the time-consuming processes. With BIM, you can streamline projects and avoid spending unnecessary time compiling designs or projects from scratch. With the right BIM objects, you save time and resources while achieving a flawless end-project that meets or exceeds your expectations.

Embedded change

With BIM, your projects will not only be compiled in the most efficient way possible, but it will also relieve you of any complications when it comes to maintenance and renewal. BIM objects are embedded with information, which makes it easy to assess details on the elements that are to be changed or renewed.

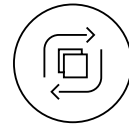

**Cost
effective**

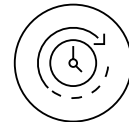

**Time
efficient**

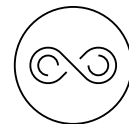

**Endless
possibilities**

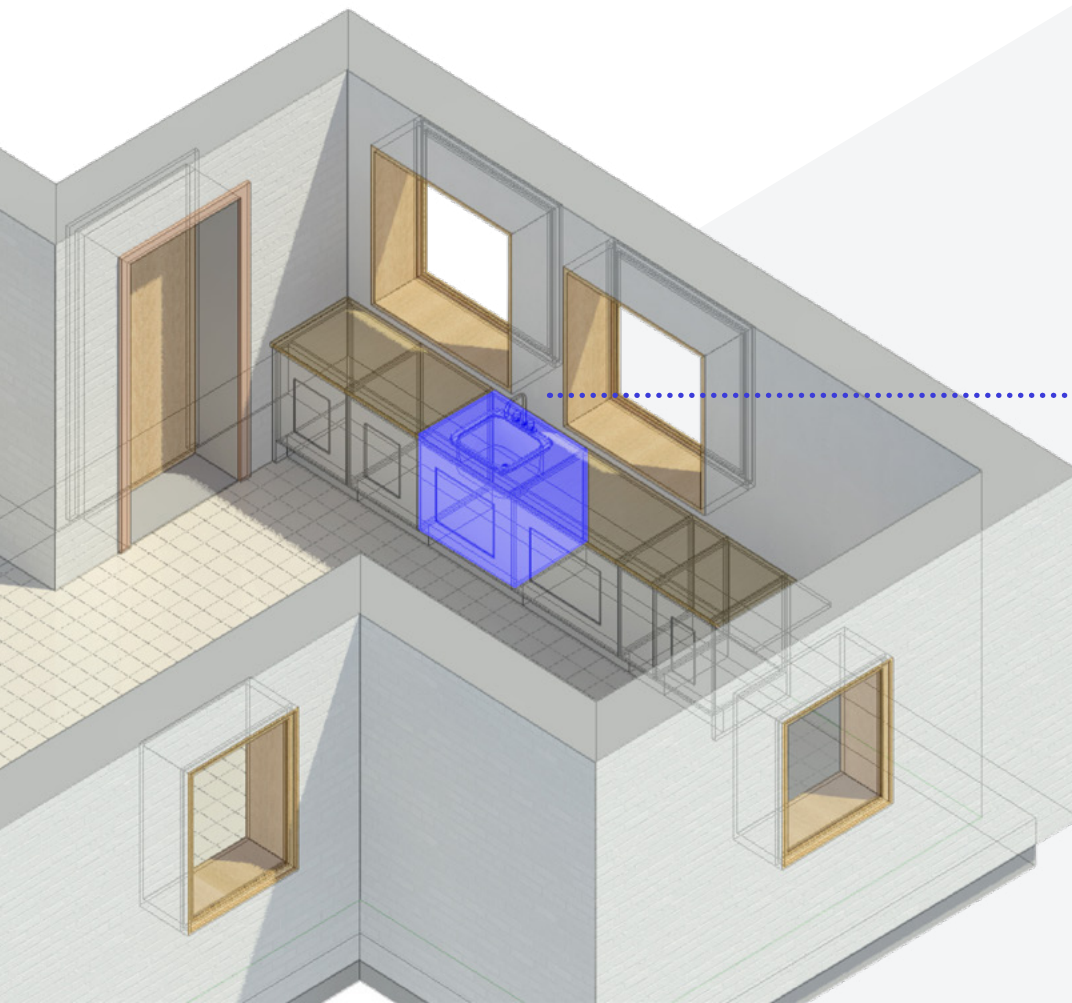

Example of BIM Countertop parameters

- Width: **800**
- Zink hole: **0**
- Zink hole width: **425**
- Zink hole height: **420**
- Counter top - depth: **635**
- Counter top thickness: **30**
- Socket depth: **525**
- Socket height: **166**

Applicability of BIM

To best accommodate the increasing complexity and high customer demands within digitalization, we offer BIM objects that will digitalize your files, making them applicable to various planner programs and sales purposes.

BIM is applied by anyone from furniture manufacturers to architects to engineers - all with different incentives. Furniture manufacturers, for instance, are increasingly employing BIM technologies to improve their position on the furniture market. By digitalizing their products, they manage to maximize their product reach while promoting customer engagement.

Even though the incentives may be slightly different, the objective is the same - organizations wish to accommodate the developing digitalization by adapting their products to it.

How we do it

Process

Albeit simplified, this illustration gives an overview of how we work with BIM. If you want to know more about the process, please reach out to your contact person, who will gladly run through it.

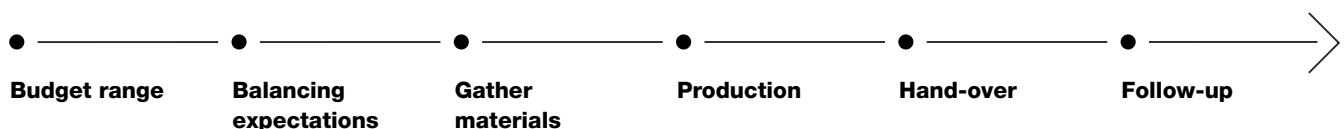

Pricing parameters

The price highly depends on the scope of the individual project.

Prior to any project, a dialogue between the contact person and the client will clarify the scope of the project. It is defined based on factors such as the complexity, the desired amount of BIM objects, the number of parameters for each respective object, and the time estimation for the entire project.

We always aspire to reproduce the design of a given object as accurately as possible. However, BIM objects will always be designed without excessive detailing to avoid heavy file-sizes that will weigh down the project data.

Thus, it is difficult to define a specific price estimate before knowing what the entire scope of the project is and what complexity of the objects is desired.

All of these factors will affect the final price.

In general, the individual BIM objects are created based on different levels of complexity:

- 1) The most common objects are directly exportable (e.g. objects with no parameters).
- 2) The second-most common objects only vary on parameters such as height or width (e.g. a type of door).
- 3) The most complex objects differ on various parameters that may implicate objects attached to them.

Further possibilities – benefit from major synergies within digital transformation

Once you've started the digital journey, lots of possibilities are just around the corner. As a full-service visual communication agency, we help our clients boost their digitalization in many ways.

For this service, this means that we always offer to assist you in the further development of your BIM project. If your company launches a new collection of furniture or you need to implement an additional element in your building project, we will be happy to provide you with the BIM objects and the service that comes with that.

When already in a partnership, future projects will require less work and hence a lower price, since we already have the information on the previously designed BIM object, and will only need the measurement and potential details for the new ones.

Furthermore, if we have had a former co-operation with your company, the previously obtained knowledge of your products will make the co-operation even more convenient and streamlined.



Example of BIM Chair parameters

- Seating height: **600**
- Back height: **900**
- Materials: **Steel with chrome plating**
- Materials: **Bamboo weave**

A comprehensive reference catalogue

200+ clients every year can't be wrong.

We work for international high-end brands within kitchen, bath, furniture, home improvement, industrial, and prefabricated houses.

Among our references you'll find:

Nobia, Poggenpohl, Bosch, Siemens, Geberit, Kingfisher, Saint-Gobain, Bang & Olufsen, Grundfos, Danfoss, Markilux, Coop, GEA, Bolia, BoConcept, Ekornes, JYSK, Electrolux Home, Hülsta, Inwido, Xella, Hafa + many more.

FAQ

Who benefits from the use of BIM?

BIM objects are most frequently used within the industries of construction, engineering, architecture, and design. Entrepreneurs within these industries will benefit from using BIM objects since it simplifies their job with regard to calculations and estimations made throughout the project. The owner of said building or construction site will also benefit from employing BIM objects since they make it possible to calculate materials in reference with building performance and maintenance.

What are the benefits of employing BIM?

A general model is unintelligent and therefore unchangeable. In contrast, if the model is built from scratch, information becomes nested into the object e.g. a table is always attached to the floor (because this piece of information is nested into the object, making it an intelligent BIM object). This allows for more flexibility and precise calculations.

Where are the BIM objects available from?

BIM files are available on various BIM databases along with organizations' own websites where users are able to download the BIM objects directly.

How much does it cost to implement BIM?

It's hard to give an exact price estimate before knowing the project scope. However, an estimate is given based on a dialogue between the client and the sales manager where the specifics of the project are clarified. It strongly depends on the size and complexity of the project.

Who should pay for the BIM models?

The manufacturer behind the modeled objects usually funds the BIM project. They own the BIM models but often choose to make the files available free of charge to better the chances of their products getting used in other potential BIM projects. Companies fund their own BIM objects but offer them to various BIM databases free of charge hoping that contractors, architects, engineers, etc. will make use of their products when compiling a BIM project. Thus, when employing BIM, companies are investing in their own products by adapting them to the future work method.

What type of software can I use for BIM?

You can employ various types of software when searching to implement your BIM objects. However, the most common types of software and the ones that our specialists support are Autodesk Revit, which is primarily used within the industry of building construction, and ArchiCAD, which is primarily used within the industry of design and architecture.